

# Steamboat Overlook

on the Mighty Mississippi at Burnside

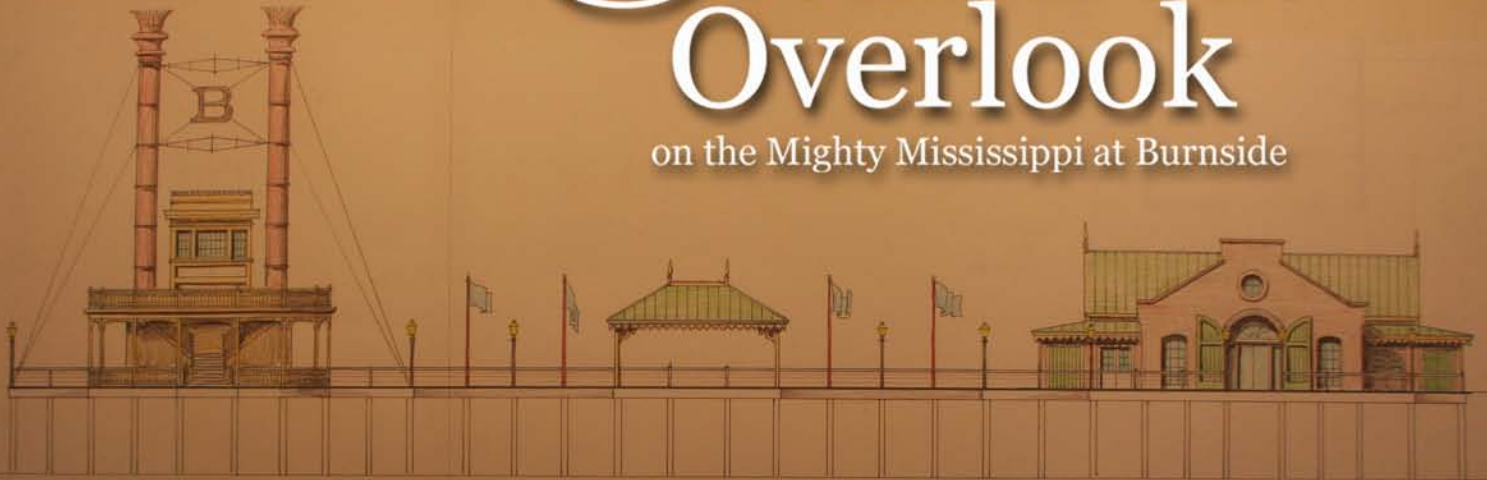

A glimpse into the history  
of life along the Mighty Mississippi



Located at Houmas Point at the great bend in the Mississippi River, Burnside, Louisiana

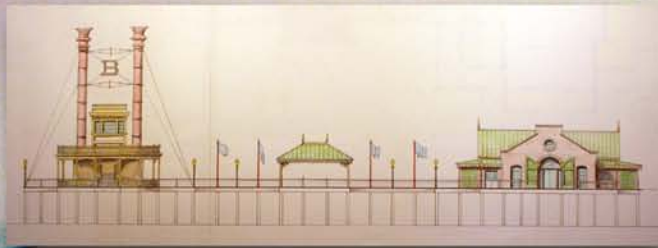

Facing Property:  
Houmas House Plantation  
and Gardens  
Open Daily for Tours

**Steamboat  
Overlook**  
on the Mighty Mississippi at Burnside

# The Warehouse Exhibit Hall

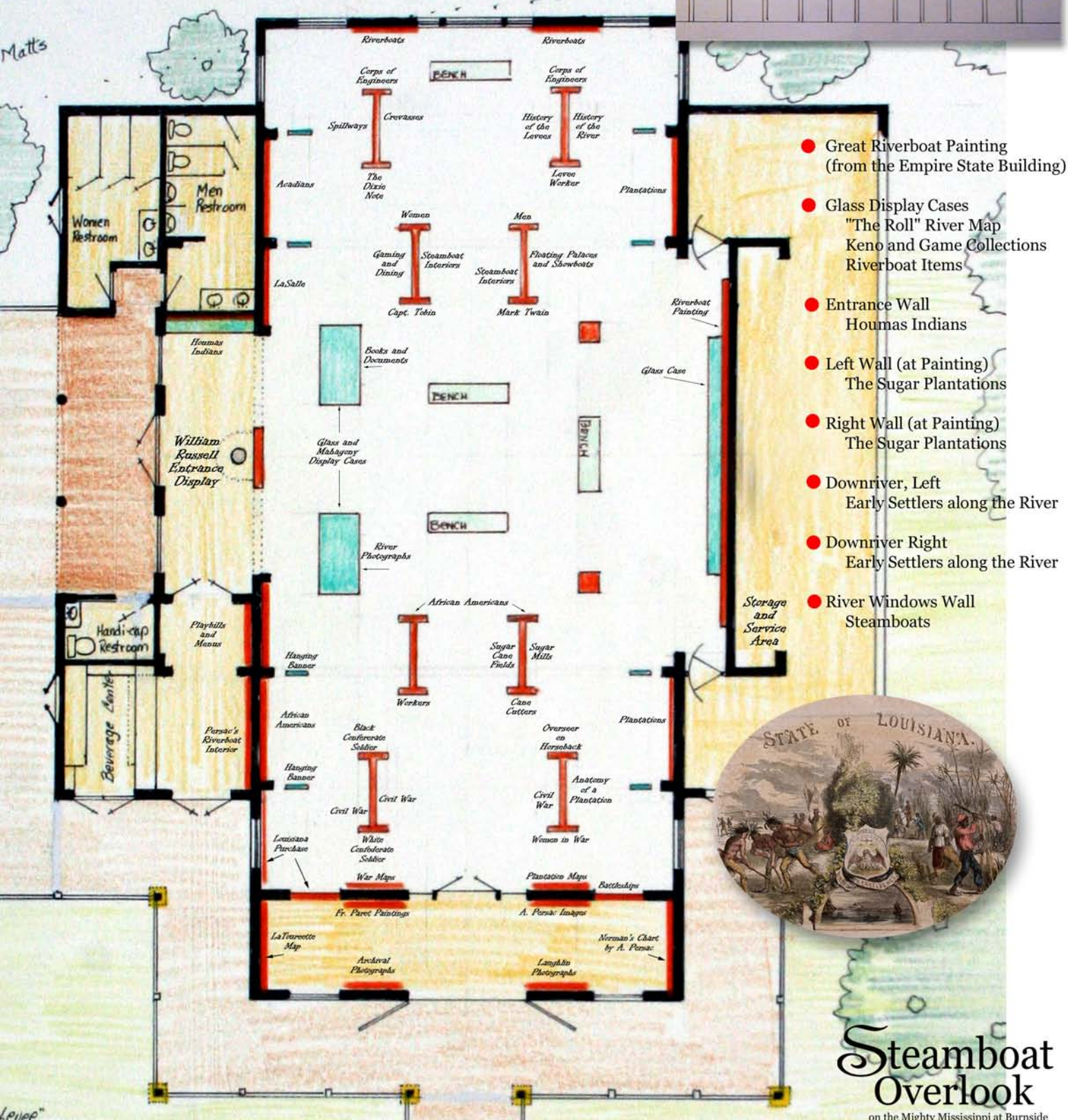

- Great Riverboat Painting (from the Empire State Building)
- Glass Display Cases  
"The Roll" River Map  
Keno and Game Collections  
Riverboat Items
- Entrance Wall  
Houmas Indians
- Left Wall (at Painting)  
The Sugar Plantations
- Right Wall (at Painting)  
The Sugar Plantations
- Downriver, Left  
Early Settlers along the River
- Downriver Right  
Early Settlers along the River
- River Windows Wall  
Steamboats

# The Steamboat Lookout

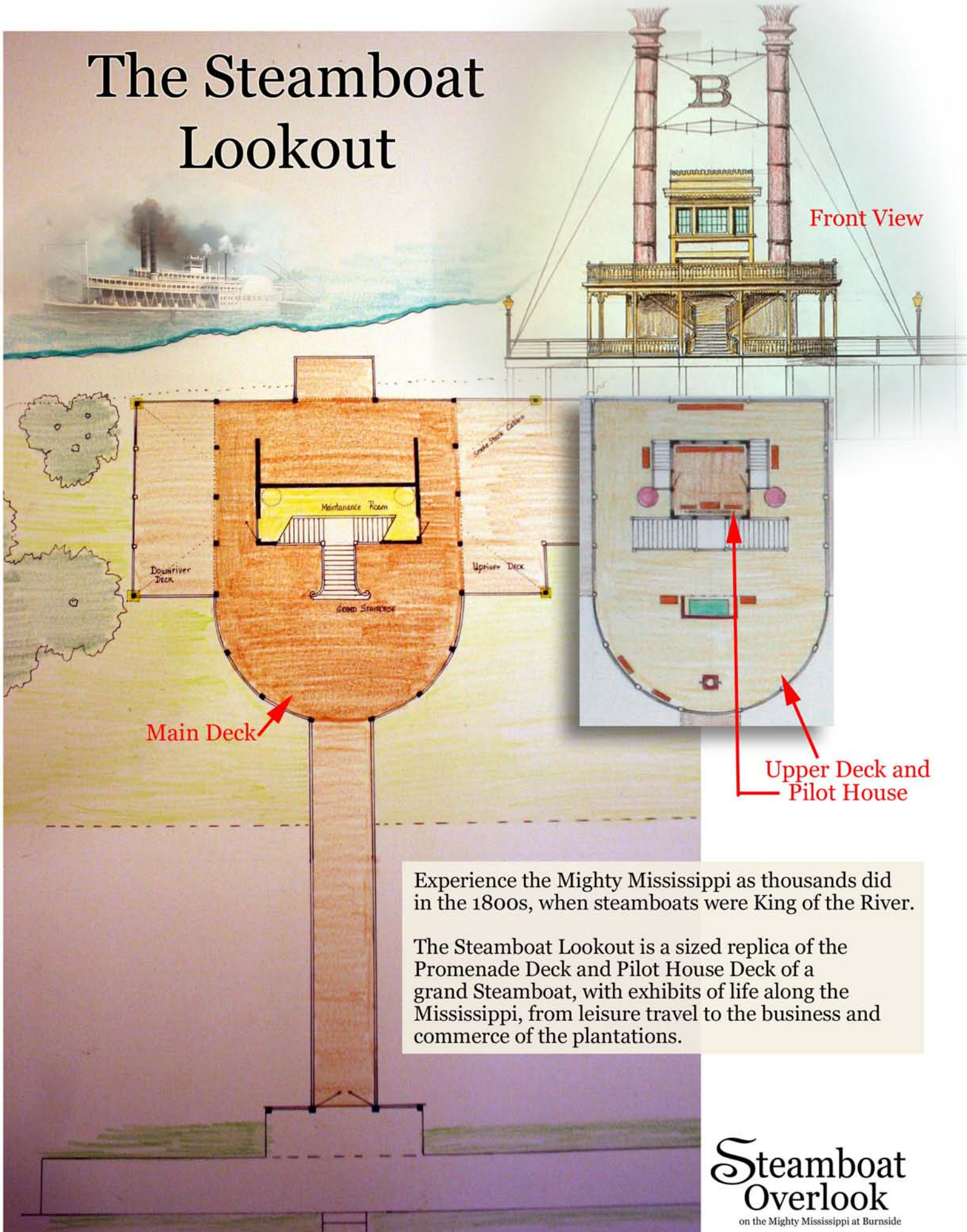

Front View

Main Deck

Upper Deck and Pilot House

Experience the Mighty Mississippi as thousands did in the 1800s, when steamboats were King of the River.

The Steamboat Lookout is a sized replica of the Promenade Deck and Pilot House Deck of a grand Steamboat, with exhibits of life along the Mississippi, from leisure travel to the business and commerce of the plantations.

# The Steamboat Lookout

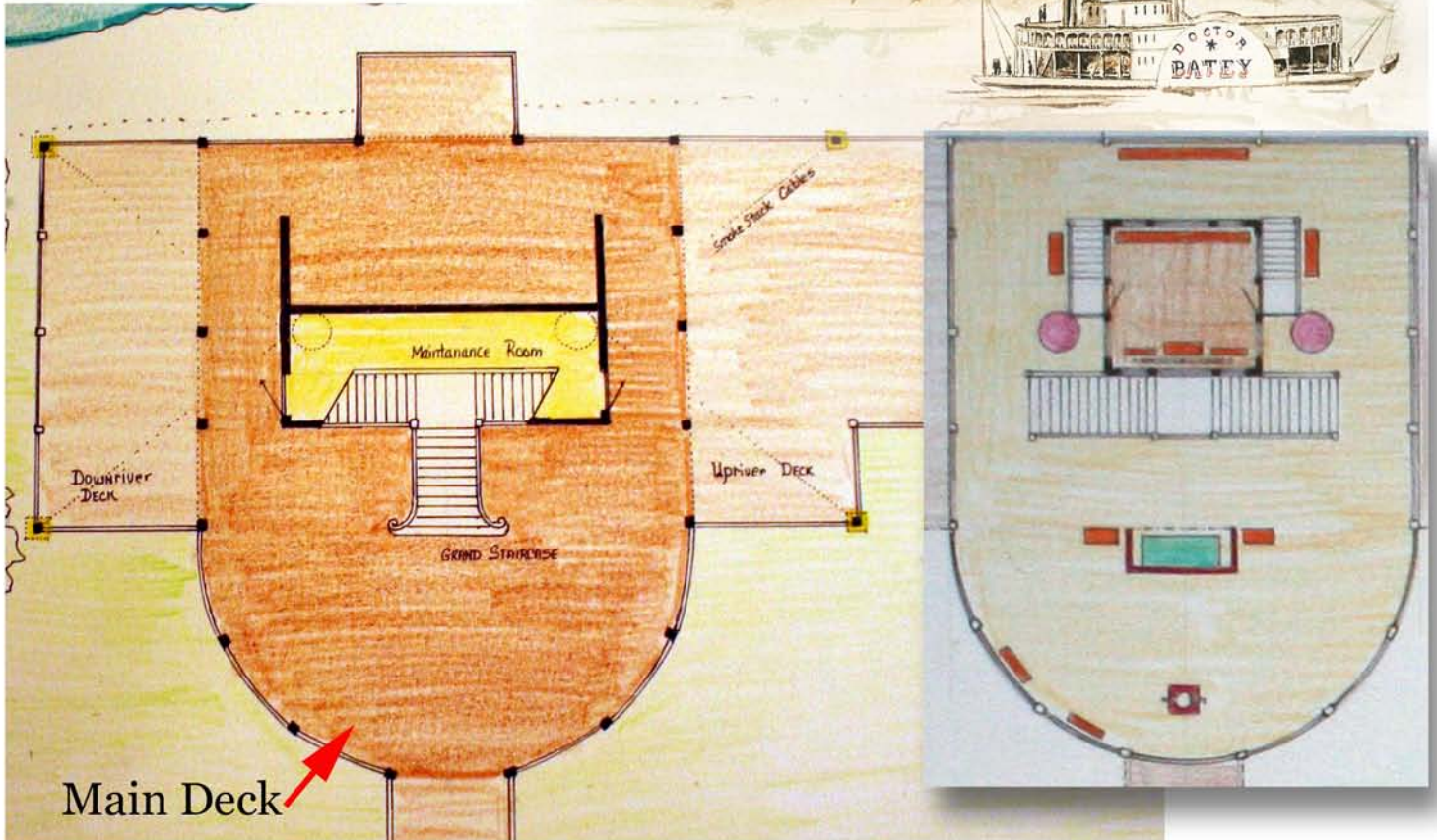
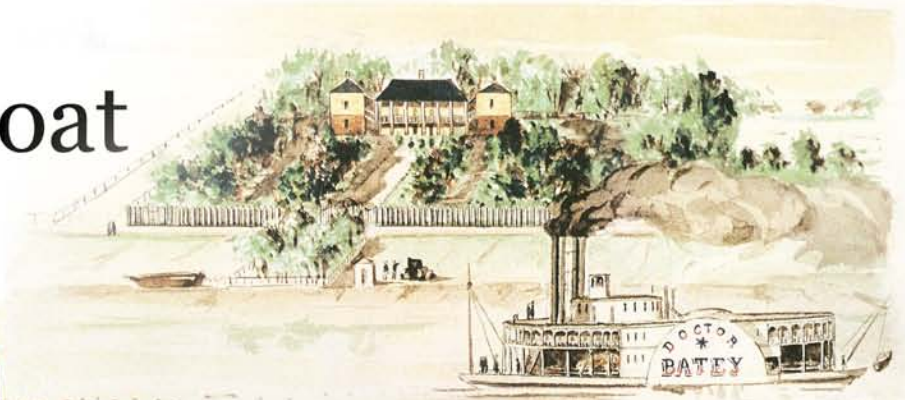

Upper Deck and  
Pilot House

## Promenade Deck Exhibits

- The Grand Staircase
- Sugar Cargo Exhibit
- Hogshead Weighing Scales
- Steam Engine
- River Navigation
- Anatomy of a Steamboat
- Paddle Wheels
- Riverboats
- Riverboat Gambling
- Grand Salons & Dining

## Upper Deck & Pilot House Exhibits

- River Navigation
- Pilot House
- Captain's Wheel
- Great Smokestacks
- Ship's Whistle
- Caliope
- Caliope Music
- Ship's Bell
- Gang Plank
- Levees

# Plantation Walk Exhibit Hall

Uncle Sam Plantation, Convent, LA

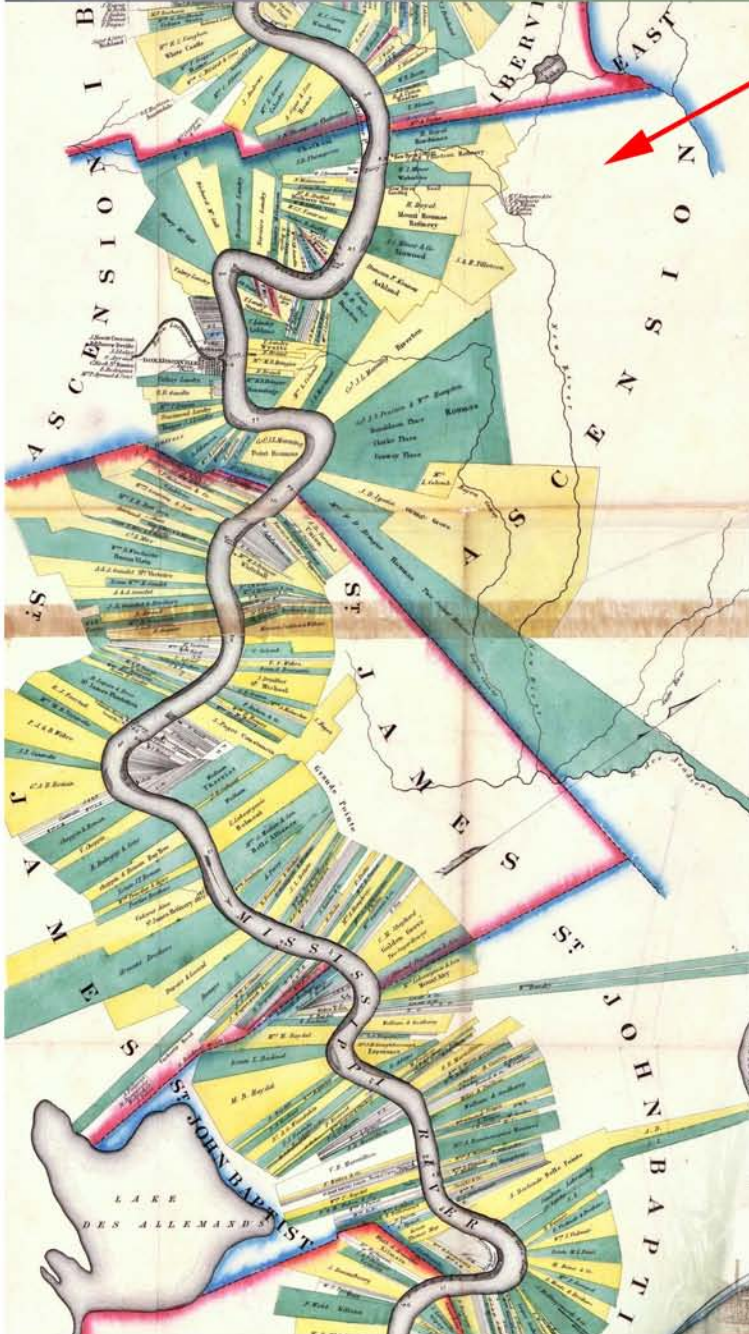

Norman's Chart will be etched on the walkway's floor.

Plantation Exhibits will be featured on corresponding walls.

The Plantation Walk Exhibit Hall, a main focus of Steamboat Overlook, will escort the visitor from the parking lot to the top of the levee, where Steamboat Lookout, the Warehouse Exhibit Hall, and open vistas are located.

Situated about 18' above the busy industrial River Road (LA Hwy 942), the Plantation Walk will be approximately 20' in width by 80' in length.

The Plantation Walk will guide the Visitor over Norman's Chart of the Lower Mississippi River. The map, which will be etched onto the floor, was commissioned and drawn by A. Persac, who traveled the river in a skiff, descending every mile, drawing every plantation line, and taking down every name and landmark on both banks.

The walls will feature exhibits of plantations which once lined the banks of the Mighty Mississippi, those lost, and those still standing.

Norman's Chart: *The New Orleans Daily Crescent* of April 2, 1858 reported "It is a perfect picture of the windings of the Father of Waters from the city of Natchez, with every plantation on its banks, drawn and colored with the name of the owner and whatever name he would have given his plantation."



# Exhibit: Plantation Display



# Exhibit: Steamboat Display



# Aerial Photo #1



# Aerial Photo # 2



# Aerial Photo # 3



# Levee Photo

